

SUPPLIERS OF TOWBAR WIRING KITS FOR THE UK

Volkswagen

| | |
|---------------|--------------|
| Golf V | 10/03-> |
| Golf Plus | 02/05->02/09 |
| Golf V Estate | 06/07-> |
| Eos | 05/06->12/10 |

Part No: VW-195-13M

Electric wiring kit for towbars / 13-pin / 12 Volt / ISO 11446 Fitting instructions

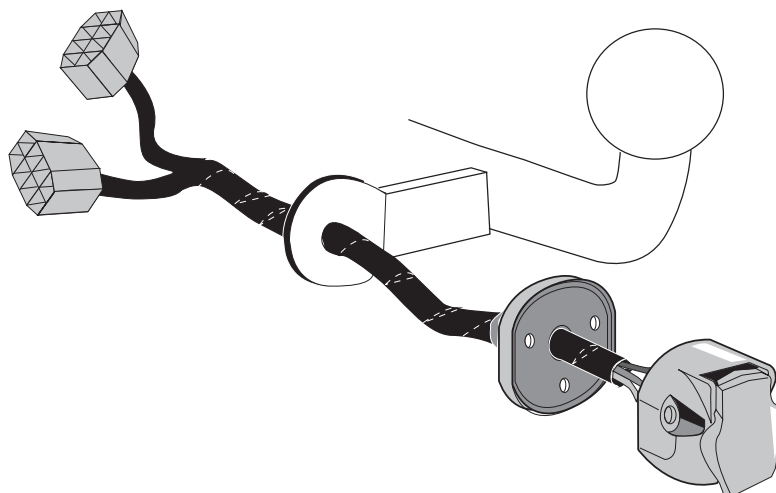

IMPORTANT!

This electric kit has to be installed by a professional workshop or a suitable qualified person.

The installation instructions must have been read and fully understood before the start of any installation. Please contact your wiring kit provider or the hotline shown in the footer should you need assistance!

Make sure the vehicle is approved/homologated by the manufacturer to tow a trailer!

Also please check that there is a definite compatibility between this vehicle and the electric kit!

Following the installation of the electric kit, the fitting instructions should be kept together with the vehicle service document and vehicle handbook. The fitting instructions contain important information relating to the use and function of the towing kit as well as for any diagnostic or activation process, that might have to be repeated in the future (e.g. after the performance of a vehicle software update).

All warranty claims will be forfeited if the electric kit or components contained therein are used incorrectly or modified. If a towing socket adaptor has been used to connect to the trailer or bike rack, this must be removed from the trailer socket once the trailer or bike rack has been disconnected.

If the trailer or bike rack is not equipped with a rear fog lamp, depending on the towing vehicle type, the correct function of the towing kit cannot be guaranteed. In such cases, a rear fog lamp should be retro fitted.

This towing electric kit will not be covered under warranty if any technical or electrical modifications or software updates have been performed by the vehicle manufacturer after the initial commissioning of the kit. That applies especially to modifications or updates which may cause malfunctions in the trailer socket or any other part of the trailer electrical equipment!

Depending on the type of trailer module used in this electric kit, diagnostic interrogation with the vehicle's electrical system may be limited or will not function. The error memory inside the trailer module may not be able to be accessed by vehicle manufacturers diagnostic system.

Error logs relating to the trailer electrical equipment, that may be generated in the vehicle manufacturers diagnostic system as a result of a test procedure, may be due to the incorrect installation of the towing electric kit or the false activation of the trailer module.

We always recommend whenever possible, the following troubleshooting process:

→ **An analysis of the vehicle's error memory and possibly clearing of all faults before the start of the installation!**

→ **Try disconnecting the trailer module from the towing harness and re-start the fault clearing process!**

→ **If in doubt, limit the time for troubleshooting to a max of 0,5 hours and call our Technical Support Team!**

Please follow our instructions carefully and always test the towing electrics using a true lighting board or a specifically designed bulb tester. If an LED tester is used, ensure it is equipped with correct load resistors or malfunctions will occur!

This instruction is subject to changes and we reserve the right to make changes to design, colour etc.

All of the data and illustrations may not be an exact representation but the text contained in this instruction must be observed!

SYMBOL EXPLANATION

| | |
|---------|---|
| | Left (58-L) respectively Right (58-R) tail light |
| 54 | Stop light (54) / high mounted, third stop light (54) |
| | Turn signal indicator left |
| | Turn signal indicator right |
| | Rear fog light(s) |
| | Reversing light(s) |
| | Permanent power supply / 13pin socket, chamber 9 |
| | Charging wire for trailer battery / 13pin socket, chamber 10 |
| | Trailer / trailer recognition |
| B+ / 30 | Permanent current power supply |
| | Ground or Earth (31) |
| | Ground connection battery terminal lug |
| | Positive connection battery terminal lug |

| | |
|--|---|
| | Cigarette lighter / accessory socket |
| | Loudspeaker / buzzer |
| | Park Distance Control |
| | Switch / source of function |
| | Connect together |
| | Disconnect |
| | Look at / See further information |
| | Look carefully at selected area |
| | Present / Occupied / OK |
| | Not present / Not occupied / Not OK |
| | Acoustic indication |
| | Attention / important advice |
| | Fuse / fuse capacity 20 Ampère |

TOOLS

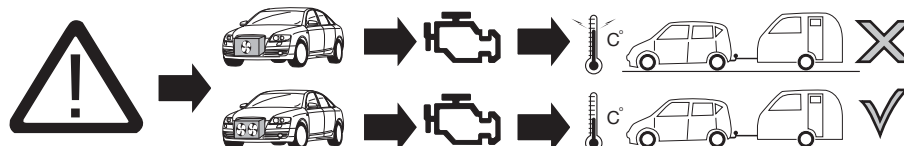
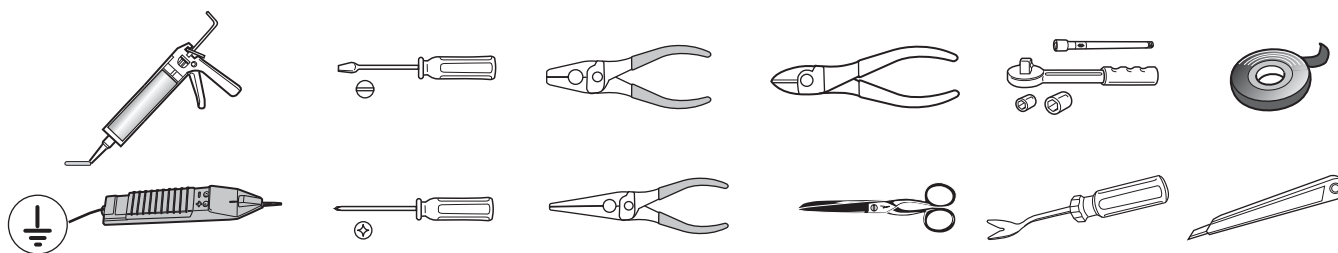

ATTENTION!

The vehicle's cooling capacity may have to be increased when retrofitting a trailer coupling!
You must observe the manufacturer's instructions!!

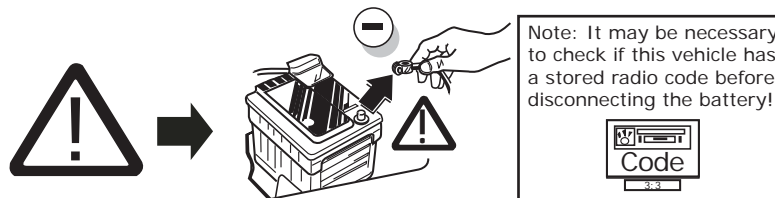

ATTENTION!

In order to avoid mal-functions and damage to the vehicle's electrical system the earth terminal **must be disconnected** from the vehicle's battery **before starting work!**

Both the trailer module and the vehicle's control unit for the electrical system can be damaged during work on the data bus connections if the battery is not disconnected!

Please pay attention to the manufacturer's instructions when disconnecting and reconnecting the vehicle's battery!

1

Golf V/ Golf Plus/ Eos

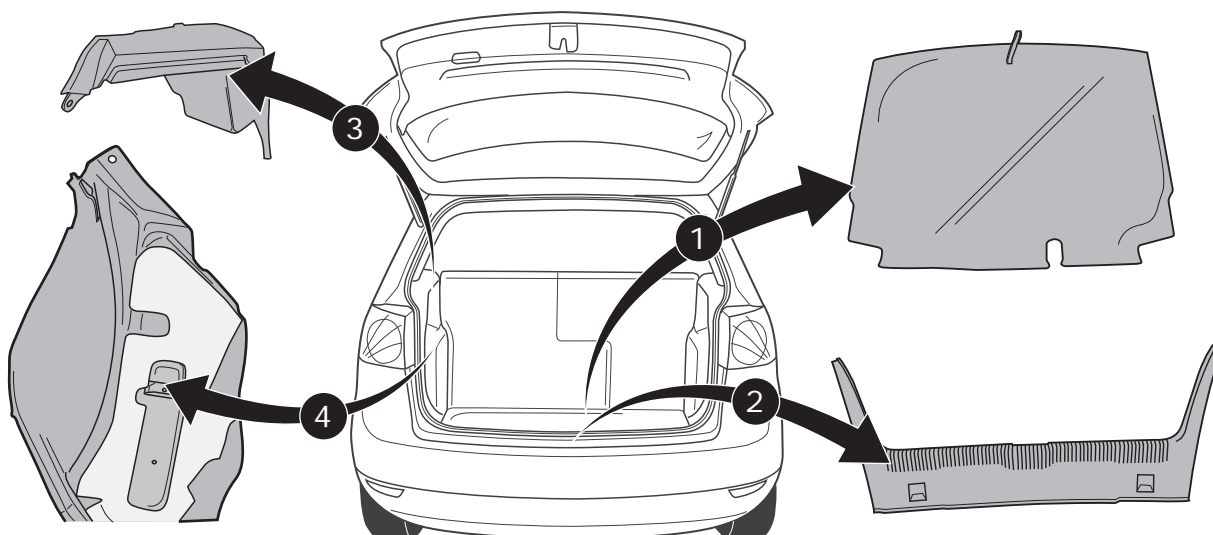

2

Golf V Estate

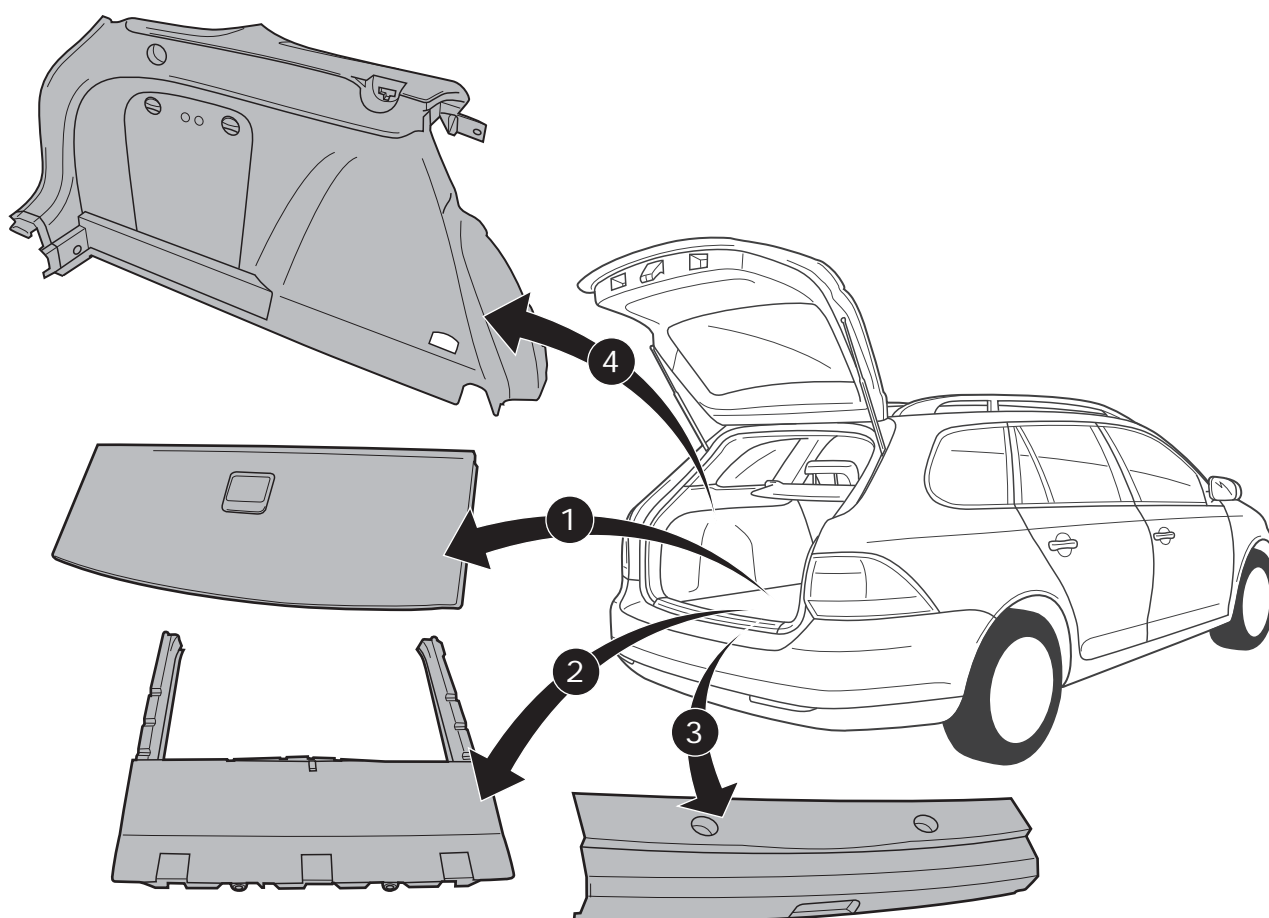

3

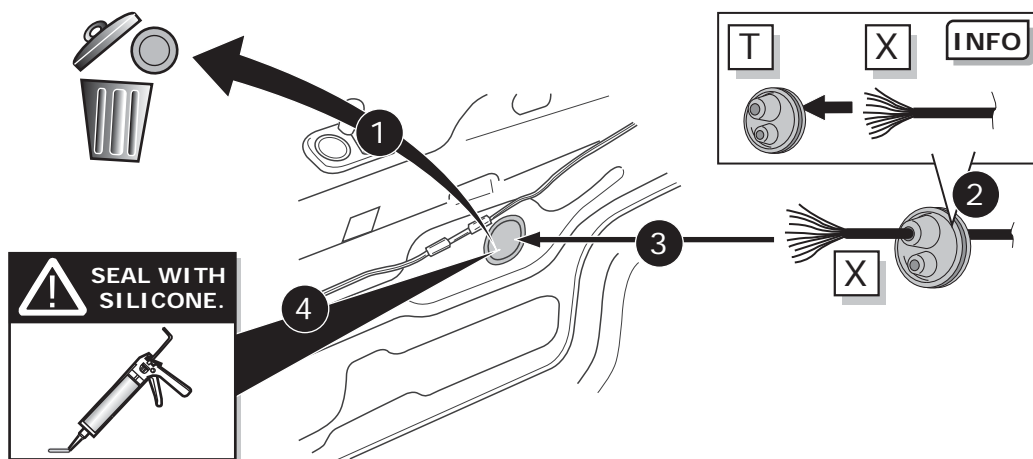
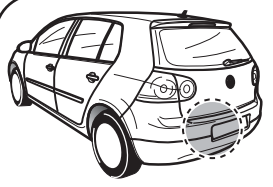

4

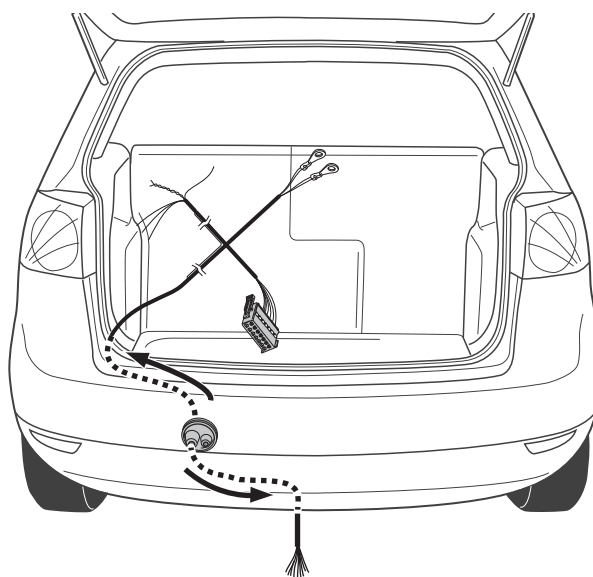

5

Option 1

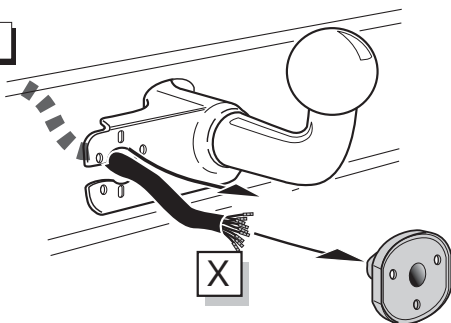

6

Option 2

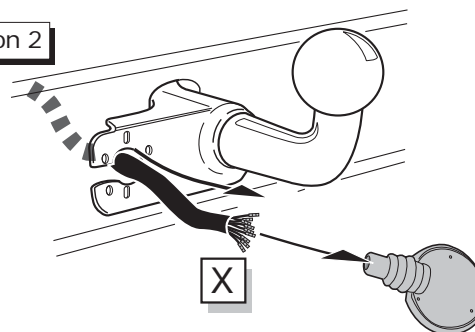

SOCKET CONNECTION

| DIN/ISO 11446 | ← L | ⊕ | ⊖ 1-8 | → R | ☀ | STOP | ☀ | Reverse | 30+ | 15+ | ⊖ 10 | — | ⊖ 9 |
|---------------|--------|------|-------|-------|--------|-------|--------|---------|--------|------|-------------|----|-----------|
| | 1/L | 2 | 3/31 | 4/R | 5/58-R | 6/54 | 7/58-L | 8 | 9 | 10 | 11 | 12 | 13 |
| Pmax | 21W | 21W | | 21W | 42W | 3x21W | 42W | 21W | 240W | 180W | | | |
| Colour | Yellow | Blue | White | Green | Brown | Red | Black | Pink | Orange | Grey | White/Black | - | White/Red |

7

Option 1

8

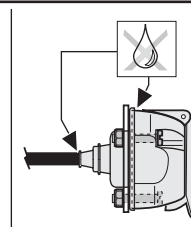
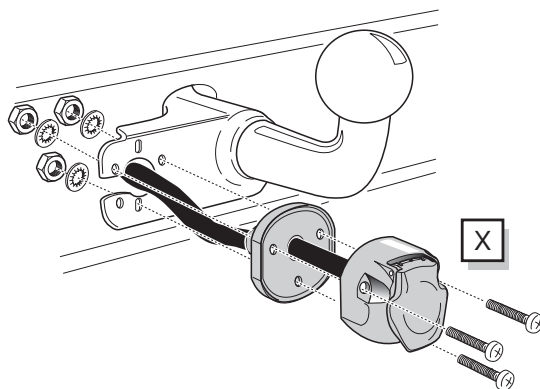

Option 2

9

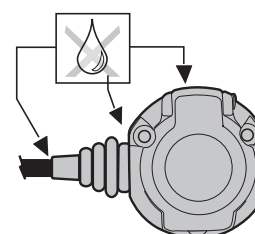
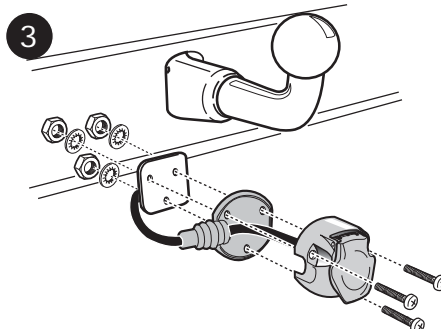
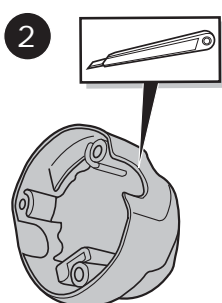
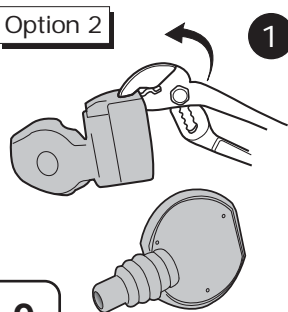

Option 2

10

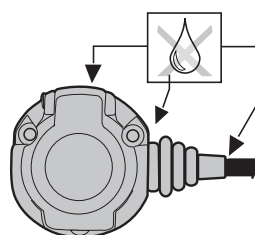
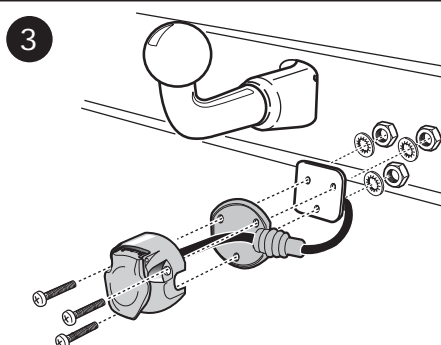
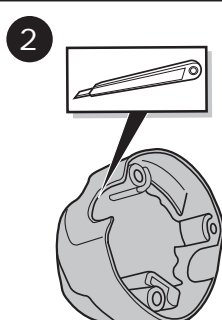
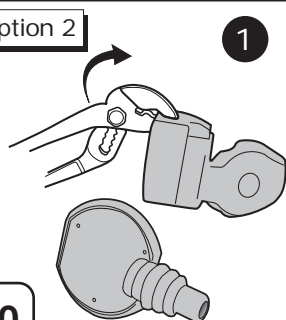

Golf V/ Golf Plus/ Golf V Estate

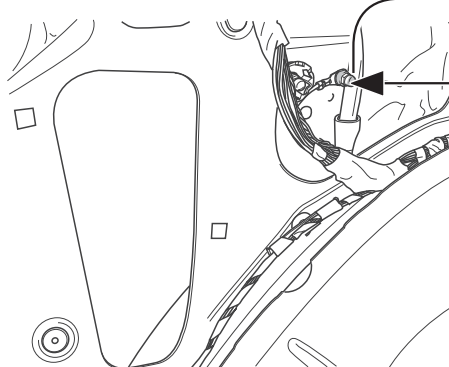
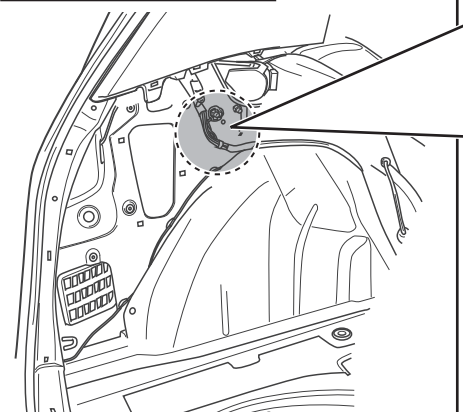
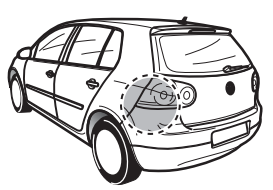

1

2

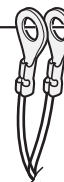
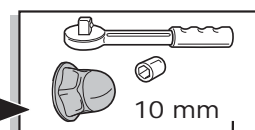

G I

11

Eos

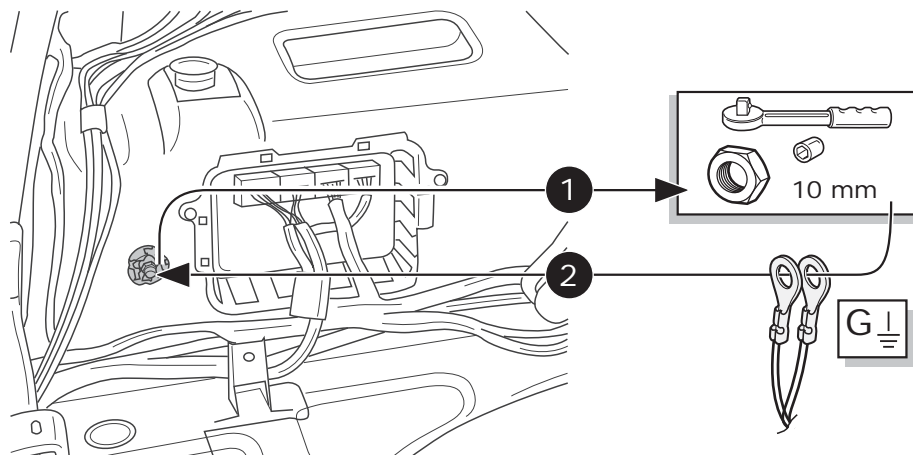
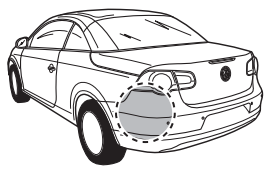

12

1

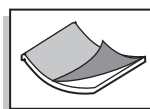

2

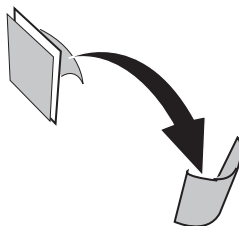

3

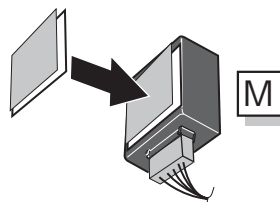

4

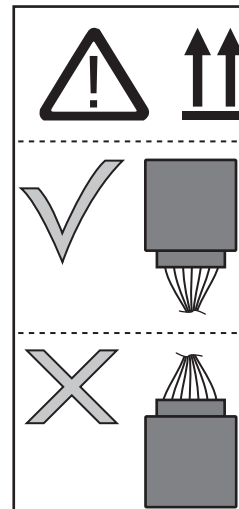
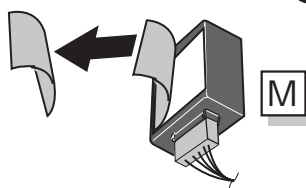

13

Golf V/ Golf Plus/ Golf V Estate

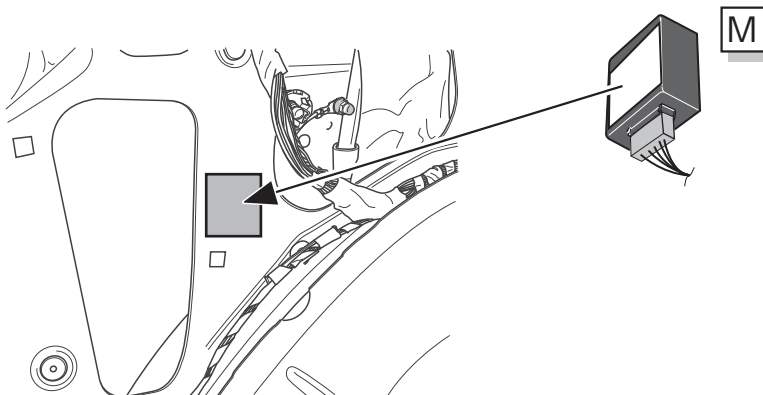
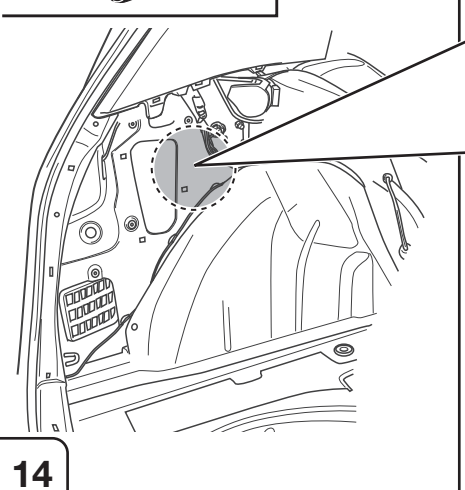
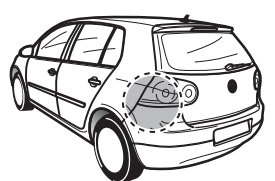

14

Eos

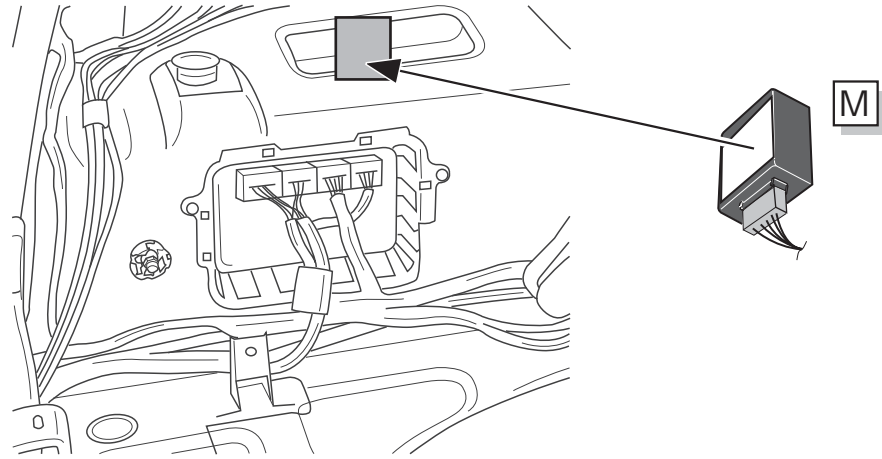
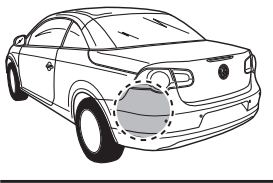

15

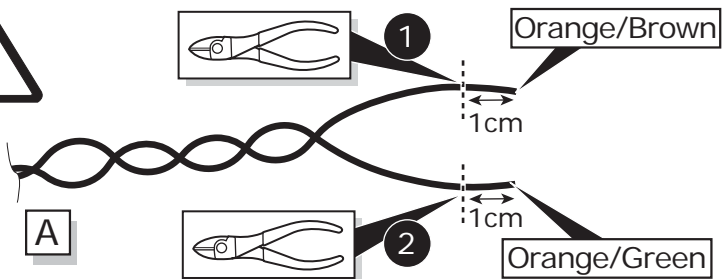
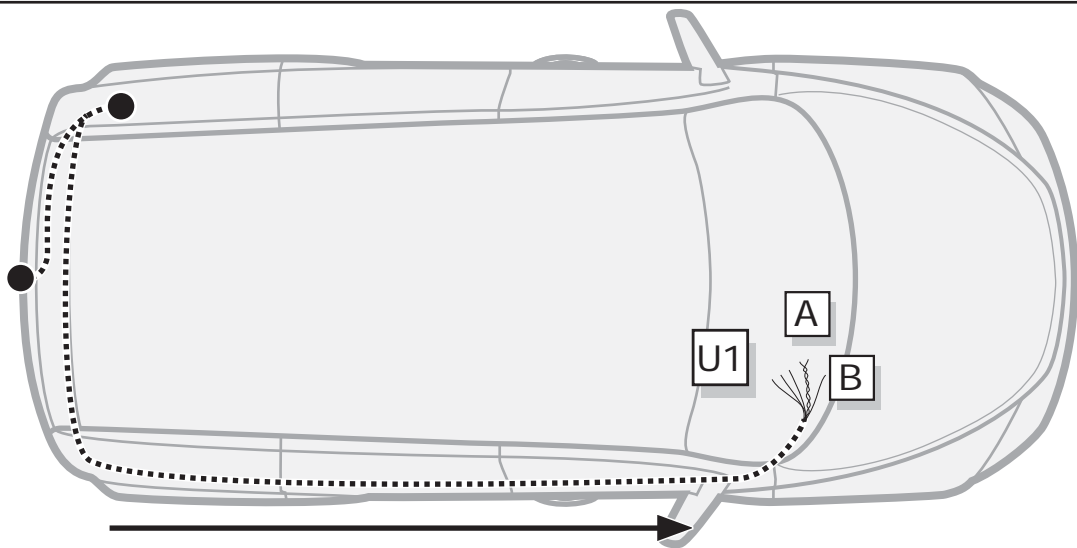

16

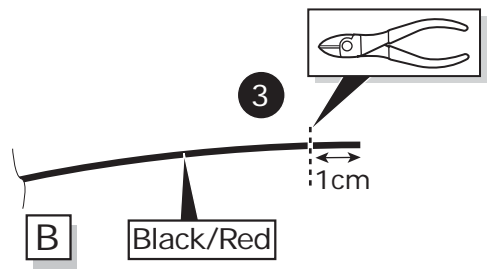

Golf Plus

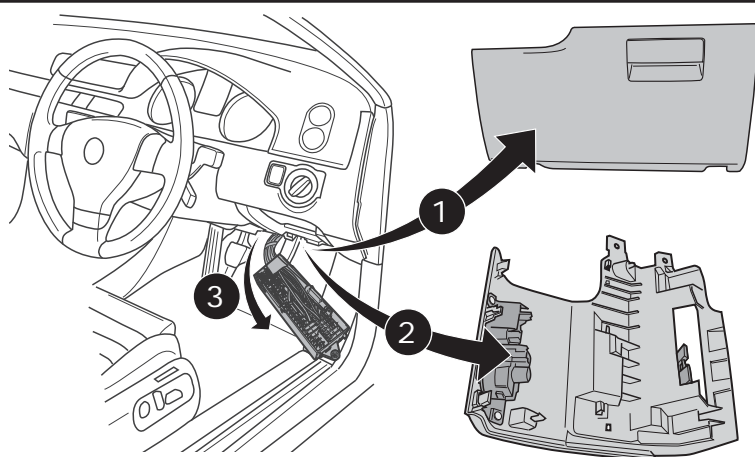
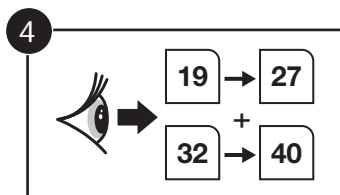

17

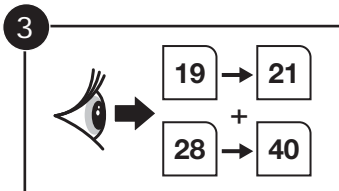
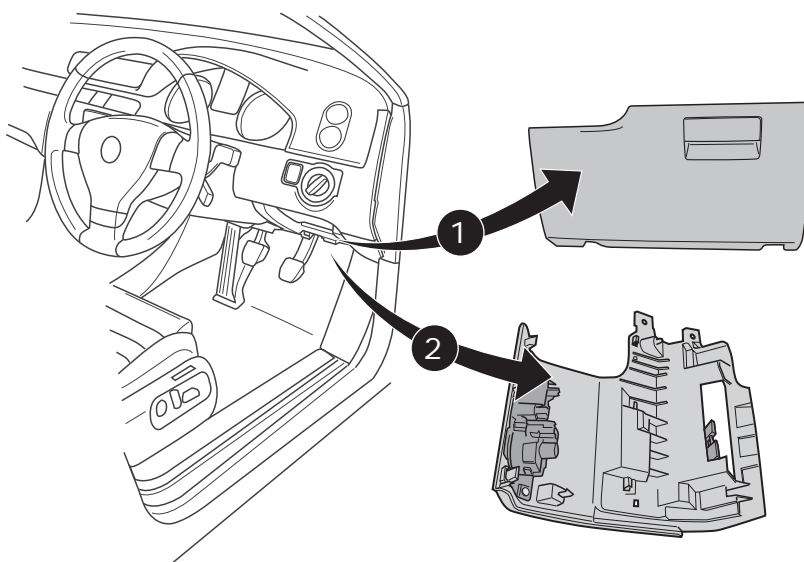

18



CAN-Data Wire

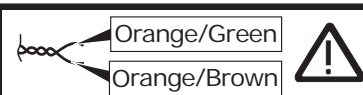

Network control unit position "G"

Important!
Please note informations
in picture 1!

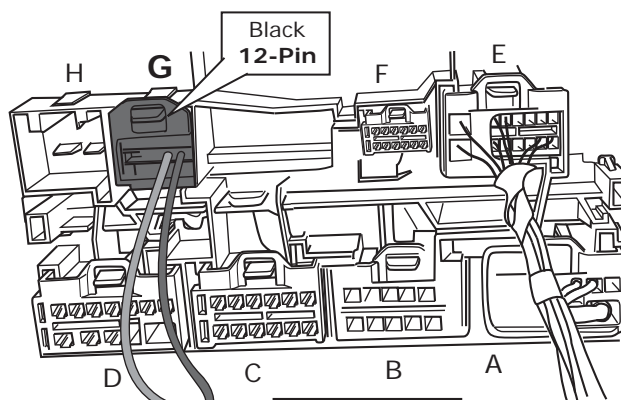
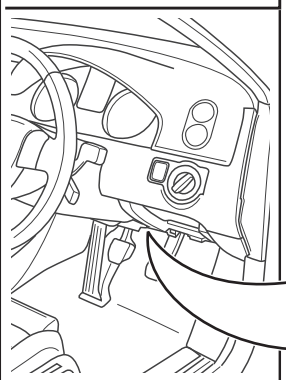

Orange/Green
Chamber 8

Orange/Brown
Chamber 7

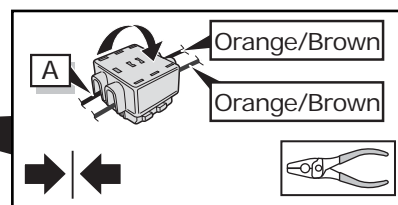
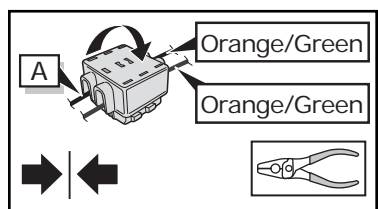

19

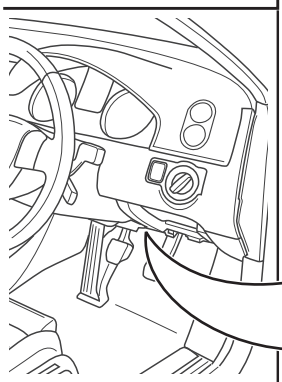

Network control unit position "E"

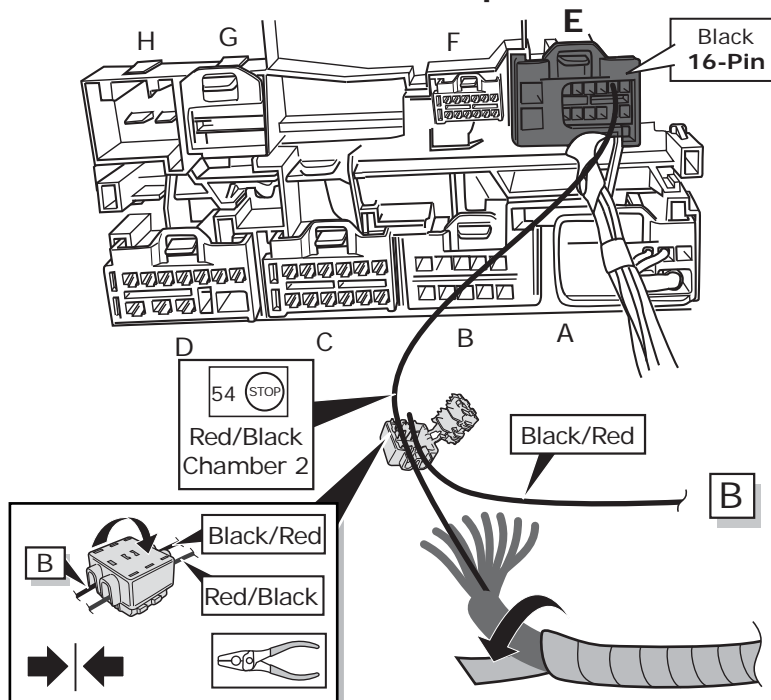

Important!
Please note informations
in picture 1!

20

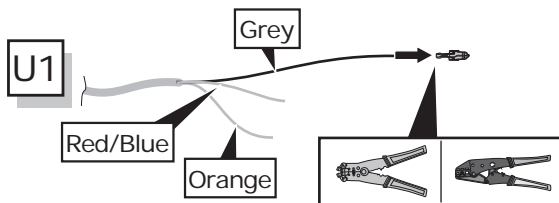

21

Golf Plus

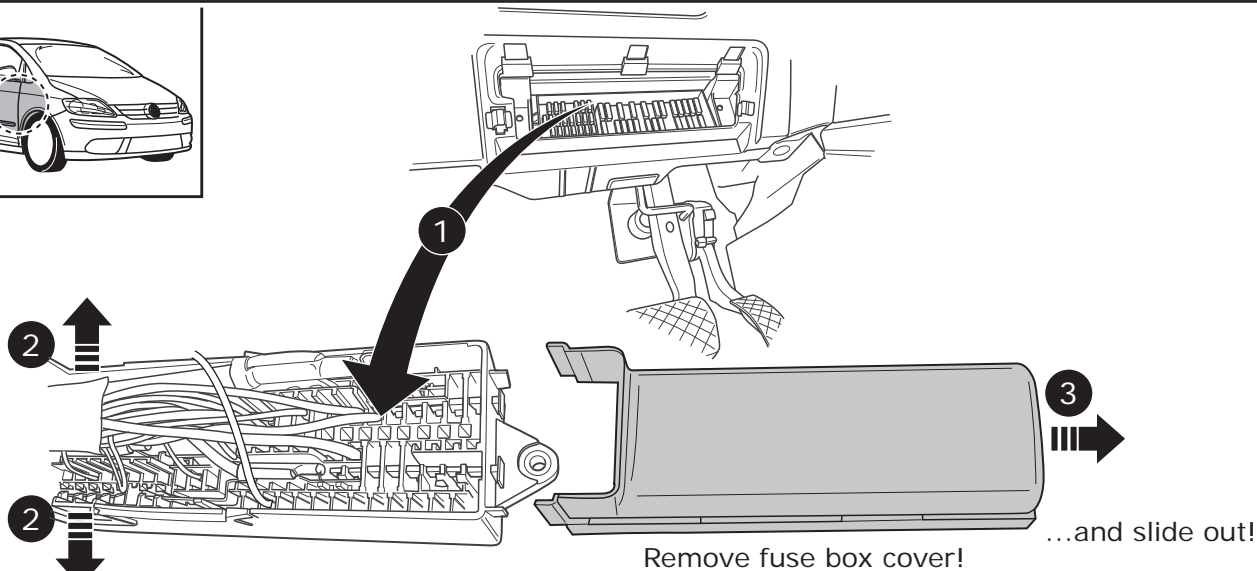

22

Golf Plus

There is prepared +30 location:

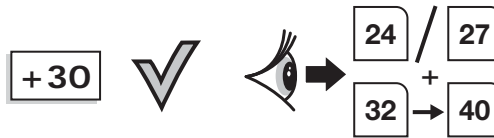

There is no prepared +30 location:

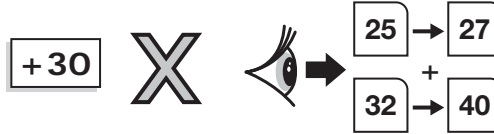

23

Golf Plus

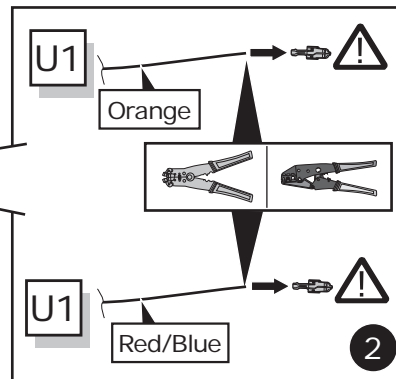
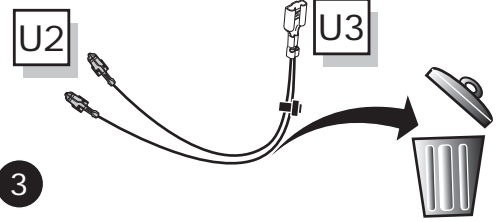
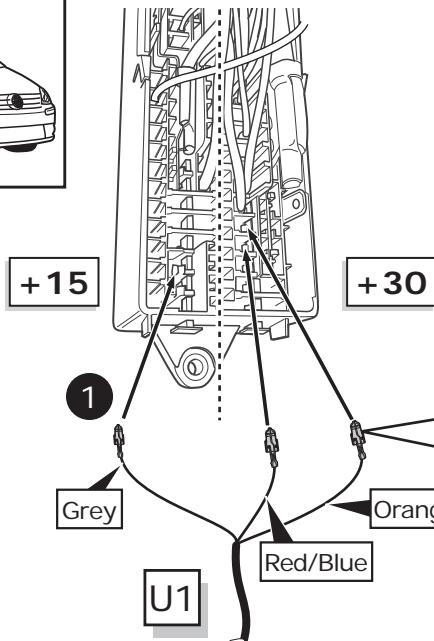

24

Golf Plus

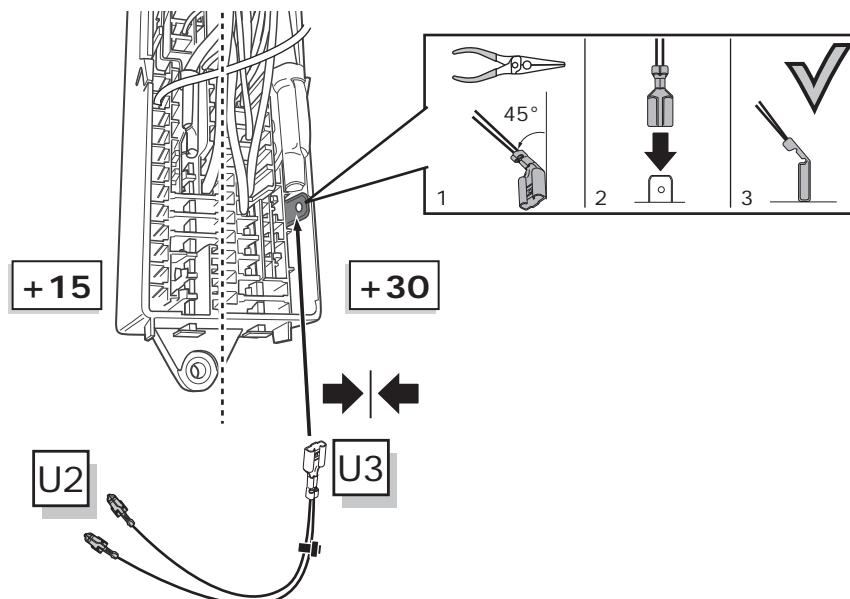

25

Golf Plus



+ 15

+ 30

1

Grey

U1

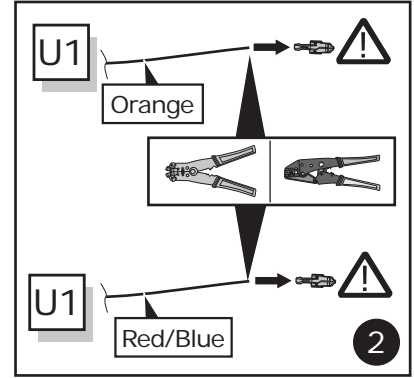

3

Search 2 unoccupied chambers

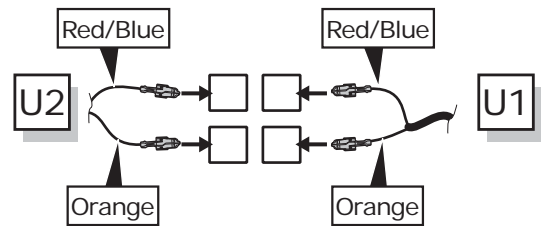

26

Golf Plus

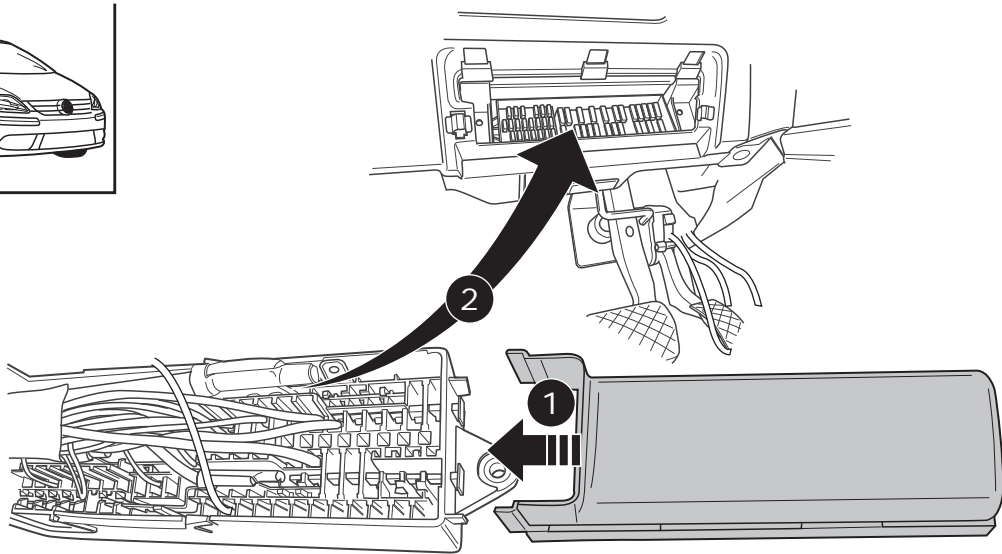

Close fuse box cover!

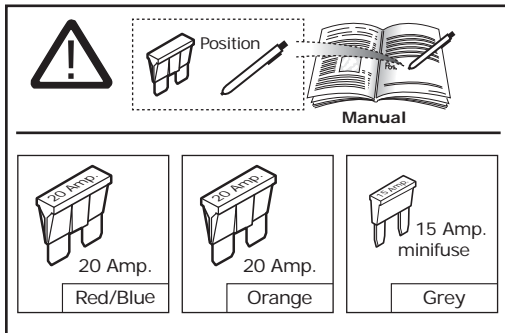

3

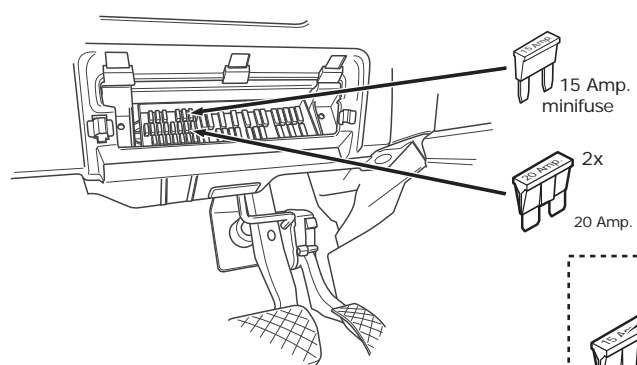

27

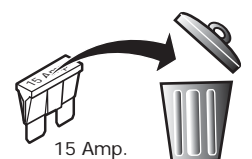

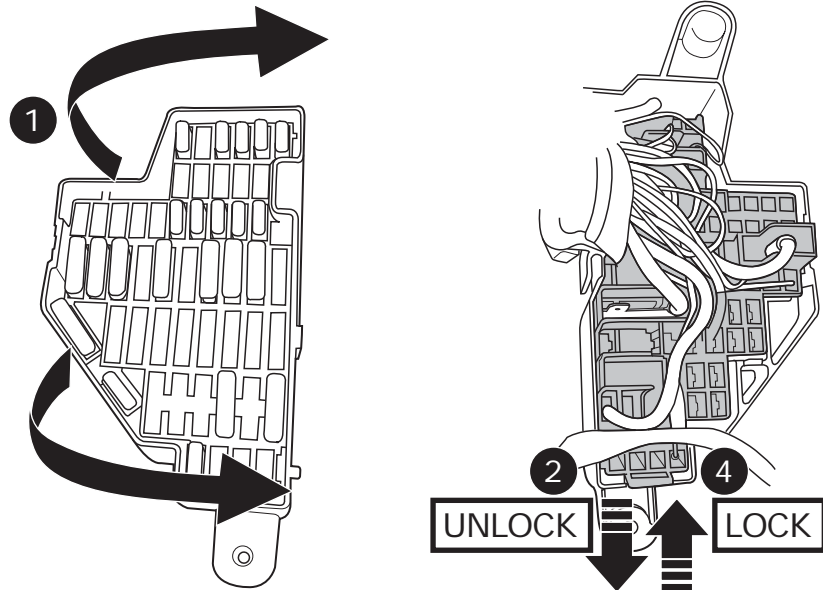
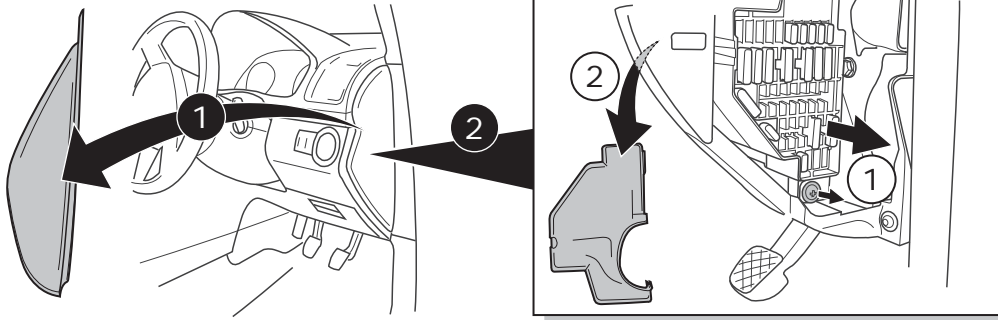

3

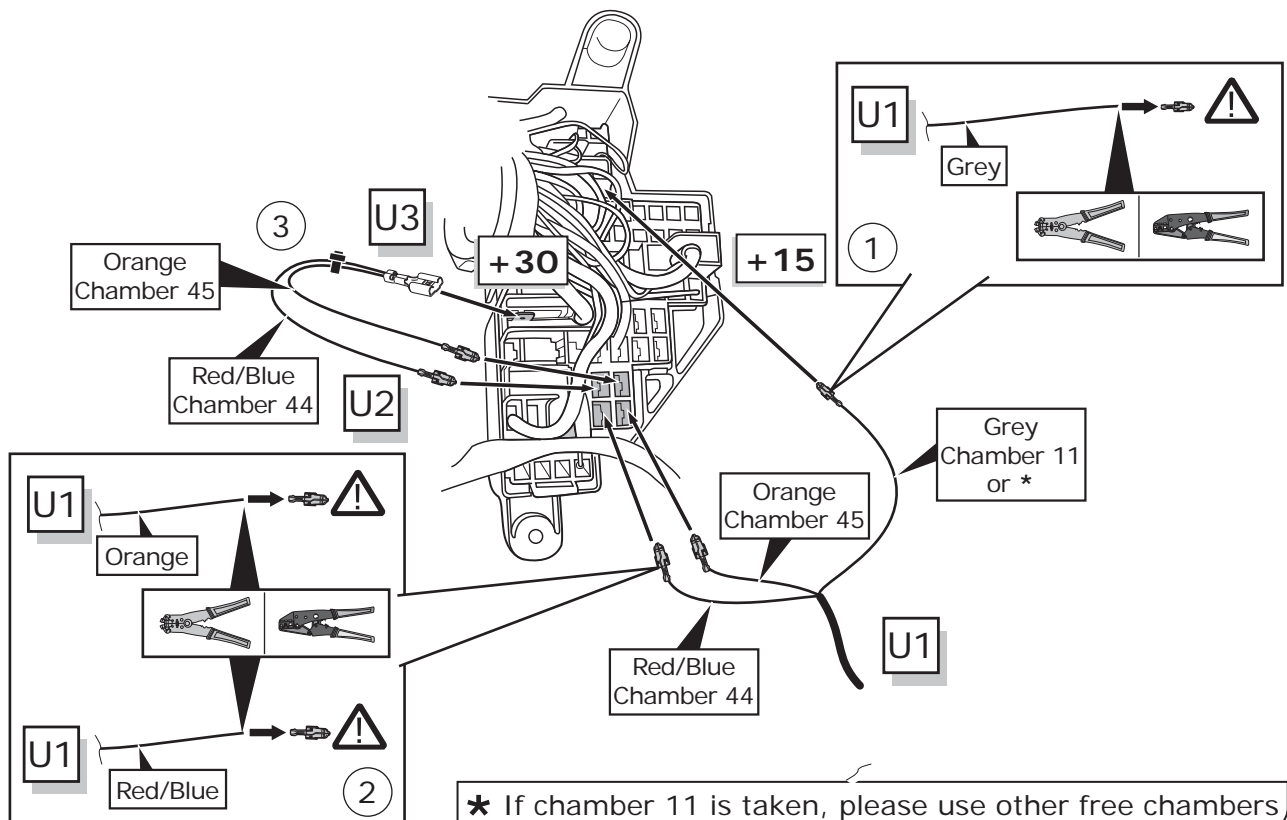

* If chamber 11 is taken, please use other free chambers

Golf V/ Golf V Estate/ Eos



★ If chamber 11 is taken, please use other free chambers

Chamber 11
or *
15 Amp.
minifuse

3

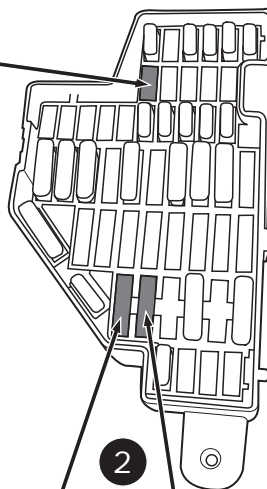

2

Chamber 45

Chamber 44



20 Amp.

20 Amp.

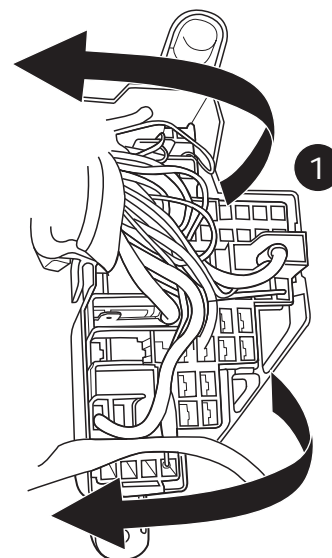

1

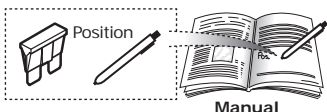

Position

Manual



20 Amp.

Red/Blue

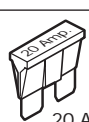

20 Amp.

Orange



15 Amp.

minifuse

Grey

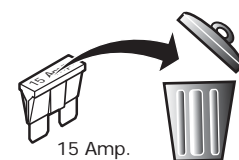

15 Amp.

30

Golf V/ Golf V Estate/ Eos

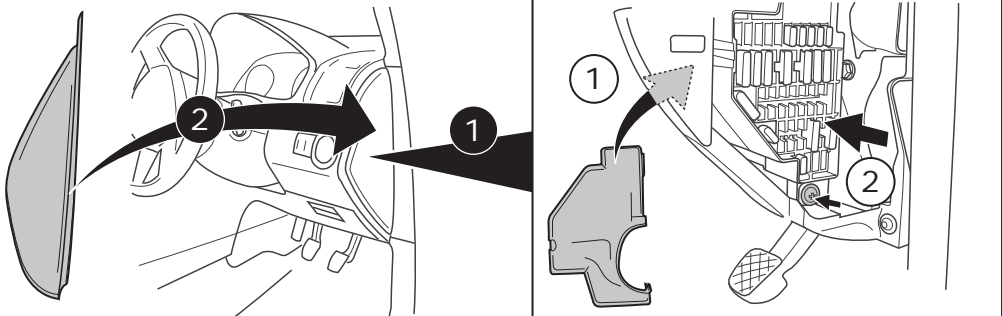

1

1

2

31

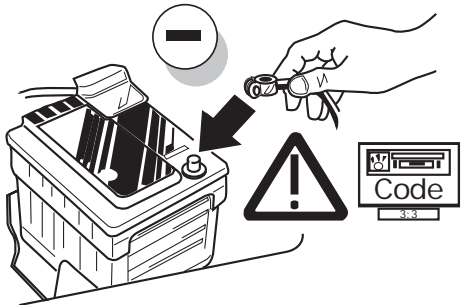

32

Set up trailer operation



Golf Plus
Golf V
Golf V Estate
Eos

02/05 -> 02/09
10/03 ->
06/07 ->
05/06 -> 12/10

General

After the installation of the electric kit, the obligatory trailer lighting as well as the trailer indicator control which is statutory in a several countries are guaranteed without having to make any connections on the vehicle!

The message "**Control unit incorrectly coded**" will, however, appear in the fault memory (19 – Diagnosis interface for data bus)! Yet this entry has no effect on the other functions and can be ignored until your next regular service appointment. We recommend the connection via the factory-mounted service tester (VAS 5051 / 5052) within the framework of the annual service intervals!

Please effect coding as follows:

- Vehicle self-diagnosis
- Gateway assembly list
- 19 – diagnosis interface for data bus
- 007-Coding (service \$1A) \ Read / write long coding
- 69 – trailer function (switch to coded!)

Vehicles with park assist system

Option 1:

After the effected connection, the rear park assist system will also automatically be deactivated in trailer operation!

Option 2:

The automatic deactivation of the rear park assist system in trailer operation will be effected by means of the subsequent coding of the park assist control unit:

- Vehicle self-diagnosis
- Gateway assembly list
- 10 - park assist system II / parallel park assist
- 008 Coding (service \$22)
- Byte 0 - bit pattern xxxxxx1
(x = accept the default values in the input field for this purpose activate input mode (BIN) !)
- confirm with OK !

NOTE:

If the vehicle's rear fog lamp does not switch off automatically in trailer mode the following code must be entered in addition to the aforementioned configuration of the central electrical system:

Vehicle self-diagnosis

- 09 Electronic central electrical system
- 007 Coding (service 1A)
- Vehicle's electrical system controller coding long
- Byte 8 - bit pattern **x1xxxxxx**
(x = accept the default values in the input field for this purpose activate input mode (BIN) !)
- confirm with OK !

Release the towing vehicle and trailer stabilisation!

For vehicles from production date 06.06.2005 which are factory fitted with a control unit that supports trailer stabilisation, **this function must be activated!**

With guided troubleshooting → Skip: Function / component selection

- Chassis
 - Brake system
 - 01 – Self-diagnosing systems
 - ABS
 - Functions
 - Adaptation – J104 with towing vehicle and trailer stabilisation
 - Next
 - Adaptation – J104 with towing vehicle and trailer stabilisation
 - Start test program, follow instructions and answer questions!
- Warning: If you answer a test program question with NO the towing vehicle and trailer stabilisation cannot be activated!

Alternative:

- Vehicle self-diagnosis
- Self-diagnosis
- 1000 - Readout gateway installation list
- 03 - Brake electronics
- 015 - Access authorisation
- 015.02 - Security access (automatic)
- Enter code word 15082
- Confirm with Q
- Back to 03 - Brake electronics
- 012 - Adaptation
- Enter channel number 56
- Switch to 1 (trailer stabiliser activated)
- Save
- Accept

33

Optional

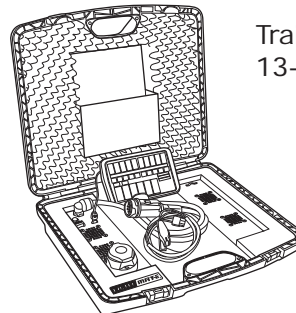

Trailer Simulator for 7- and 13-pin Sockets

34

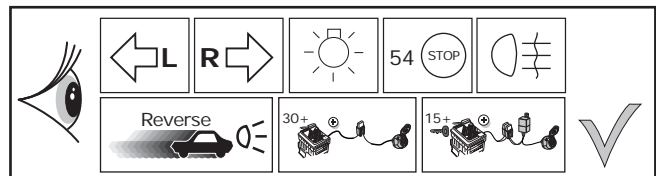
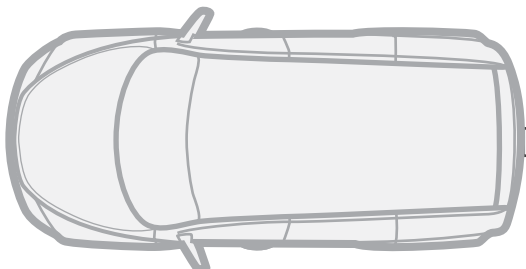

35

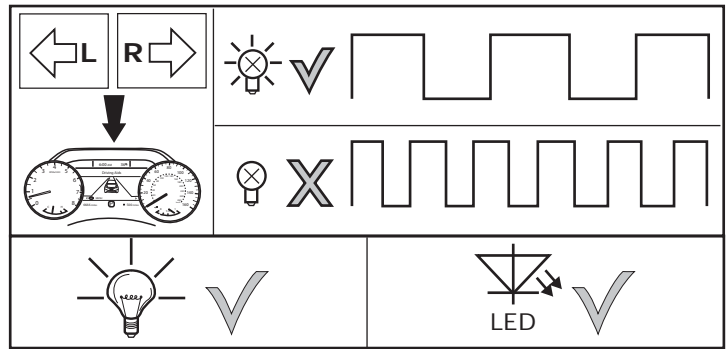
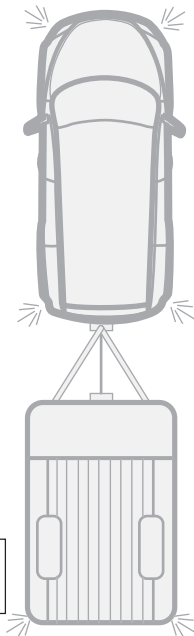

36

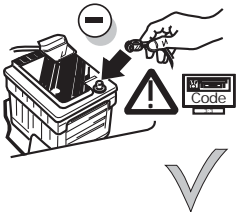

37

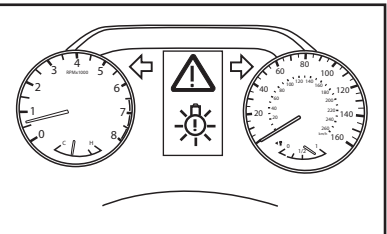
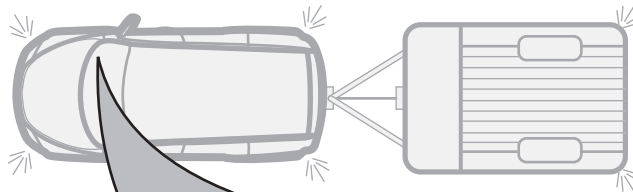

Optional

Adapter socket

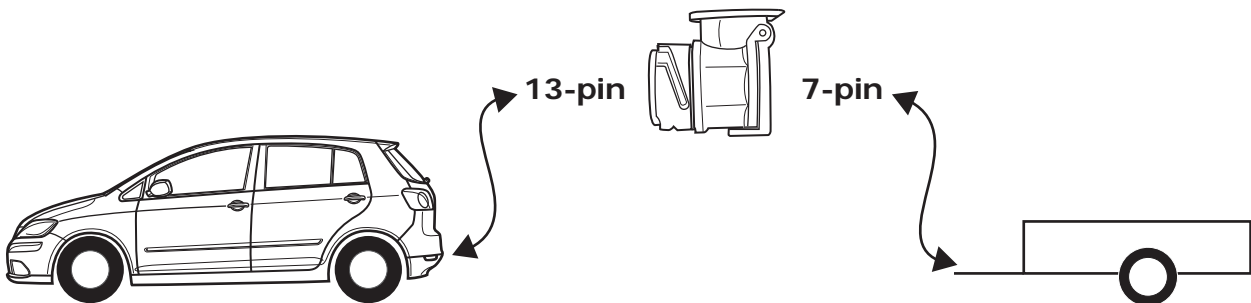

38

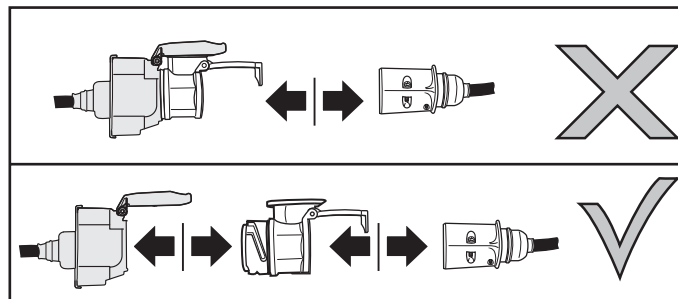
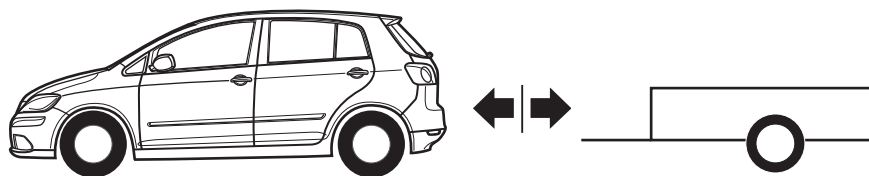

39

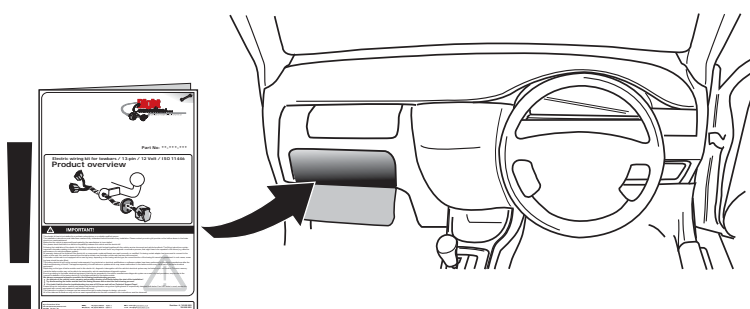

40